



Spare parts catalogue

**Winch**  
**S15**

**DINAMIC OIL S.p.A.**

Via Togliatti, 15  
41030 Bomporto (MO)  
tel +39.059.812611  
fax +39.059.812603  
dinamicoil@dinamicoil.it

Spare parts catalogue No.

**L438**

Logbook code

**921610103E**

Edition

**05/03/2015**

Revision

**0**



<b>Table index</b>	<i>Winch</i>	<b>S15</b>
	<i>Logbook code</i>	<b>921610103E</b>

<b>Page</b>	<b>Table code</b>	<b>Table heading</b>
3	<b>921610103E-1</b>	WINCH S15 DX L.F10 PR.FIN. VOC120
4	<b>921610103E-2</b>	WINCH S15 DX L.F10 PR.FIN. VOC120
5	<b>02981041</b>	BRAKE GROUP S15/S19 OMSU
6	<b>905156000-1</b>	CABLE TENSIONER PREARRANGED FOR S15-S19
7	<b>905156000-2</b>	CABLE TENSIONER PREARRANGED FOR S15-S19
8	<b>905000102</b>	MICROSWITCH KIT

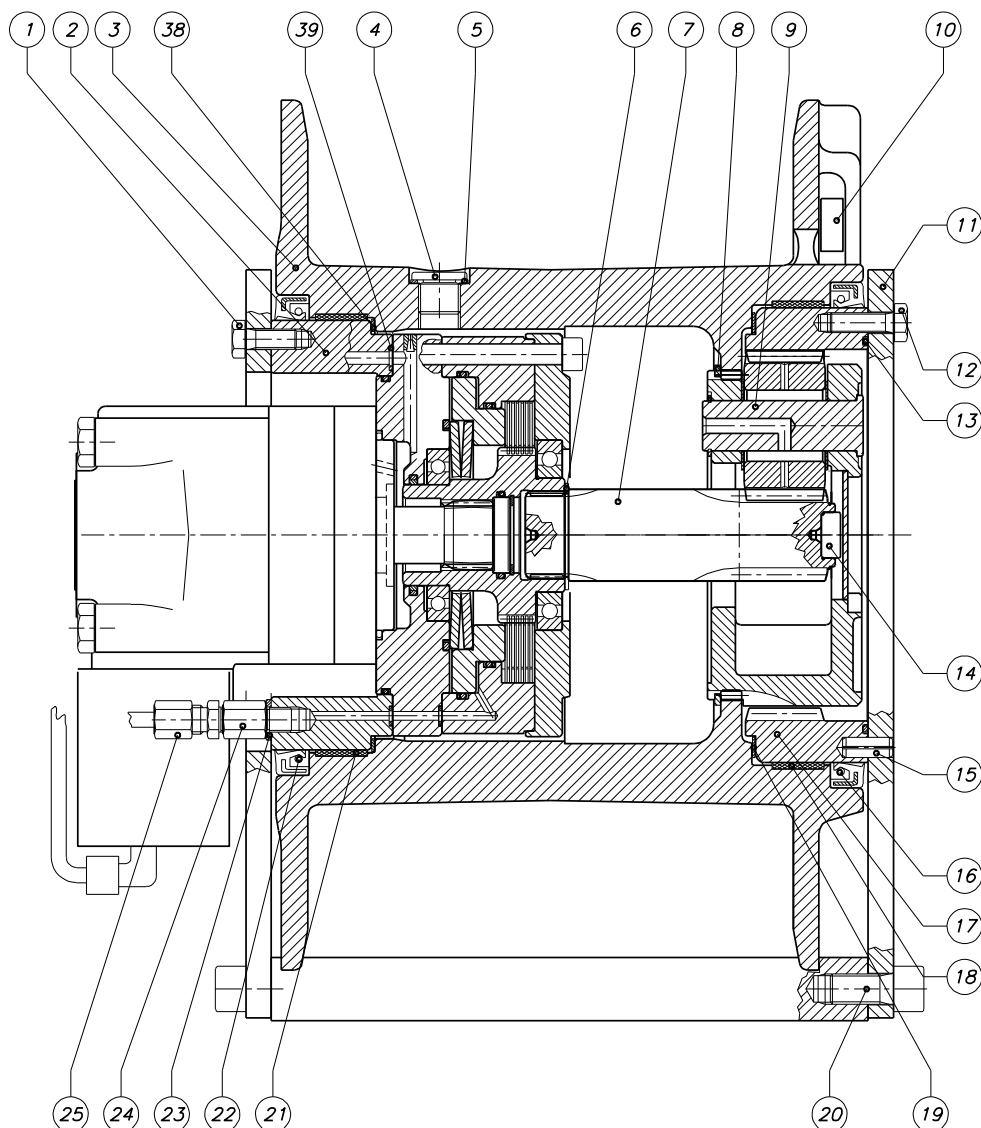

Pos	Code	Qty	Description
1	410208900	6	HEX HEAD CAP SCREW M8X20 8.8 UNI 5739
2	02981041	1	BRAKE GROUP S15/S19 OMSU
3	02301011	1	DRUM S15-S19 (CASTING)
4	419000700	2	HEX SOCKET HEAD CAP PLUG 3/8"GAS DIN 908
5	423000600	2	3/8" COPPER WASHER UNI 6953
6	421000500	1	SHAFT SEEGER Ø35
7	02611016	1	SUN GEAR RE 250 R=1:5,8 S15-S19
8	415022100	1	SHOULDER RING WR130 FOR SHAFT
9	4050001000	1	GEAR SUBASSEMBLY P15/S15 RE 250 1:5,7
10	241000000	1	THIMBLE BH215-220-P15-S15 Ø10
11	02340212	1	GEAR SIDE SUPPORT S15-S19
12	410201100	16	HEX HEAD CAP SCREW M8X25 10.9 UNI 5739
13	406016800	1	O-RING 2-163 N 674-70 (PARKER)
14	01021000	1	WHEEL GEARBOX PAD EH 200 PD
15	434010500	4	ELASTIC PIN Ø8X20 UNI6873 HEAVY TYPE (ISO 8752)
16	415012800	1	OIL SEAL 180X200X13 BASL
17	02231008	1	TOOTHED RING GEAR S15-S19
18	405022900	1	GUIDE RING ATS-F 180X185X19.5 RFG
19	427016400	1	THICKNESS SHIM ADJUSTMENT 160X176X1
20	410407700	8	HEX SOCKET HEAD CAP SCREW M12X25 12.9
21	405022800	1	GUIDE FIXING ATS-F 170X175X19.5 RFG
22	415090400	1	OIL SEAL 170X190X13 BASL
23	423203900	1	RUBBER WASHER 1/8"GAS
24	442025600	1	SHORT STUD MF 1/8 L=17
25	440001000	1	STRAIGHT CONNECTOR 1/8"G CONICAL Ø6 PIPE
38	294131100	1	SHIMMING RING P6 160X170X1
39	406001400	1	O-RING 2-010

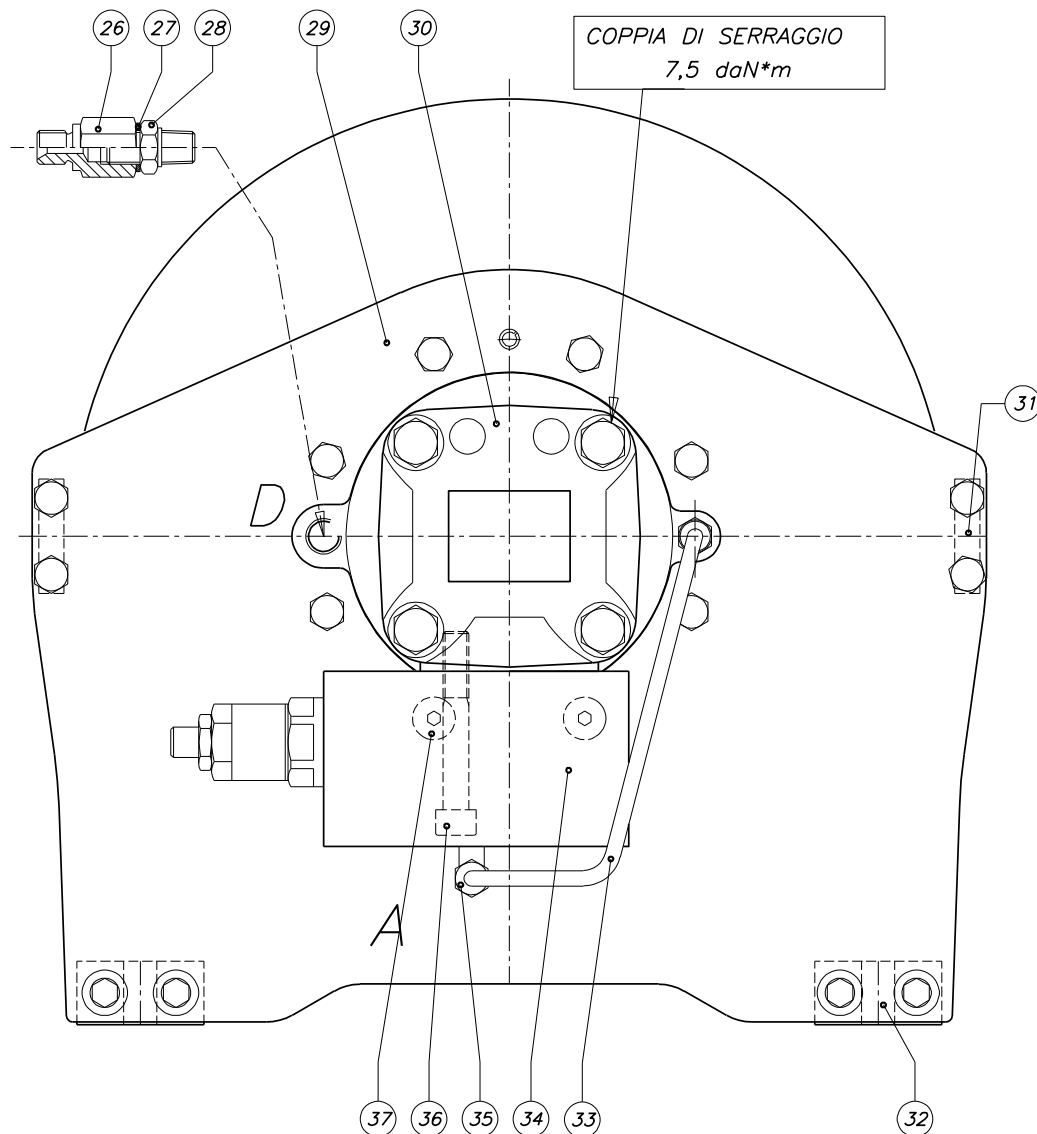

Pos	Code	Qty	Description
26	442024500	1	SHORT STUD MF 1/4"G L=32
27	423000300	1	SOFT COPPER WASHER 1/4" 13X19X1.5
28	442024800	1	JOINT 1/4 MM GAS CONICAL-CILIND..
29	02340211	1	MOTOR SIDE SUPPORT S15-S19
30	425026200	1	MOT.DANFOSS OMSU 160 3S.151F0581
31	02451002	2	CROSS MEMBER S15
32	02451003	2	FIXING PLATE S15
33	026710117	1	BRAKE PIPE S15-19 CW VALVE HBS
34	438022100	1	VALVE VOC120
35	440000100	1	CONNECTOR 90° 1/8"BSP TAPERED Ø6 PIPE
36	410406100	2	HEX SOCKET HEAD CAP SCREW M10X70 12.9
37	410040400	2	HEX SOCKET COUNTERSUNK HEAD CAP SCREW M8X20 10.9

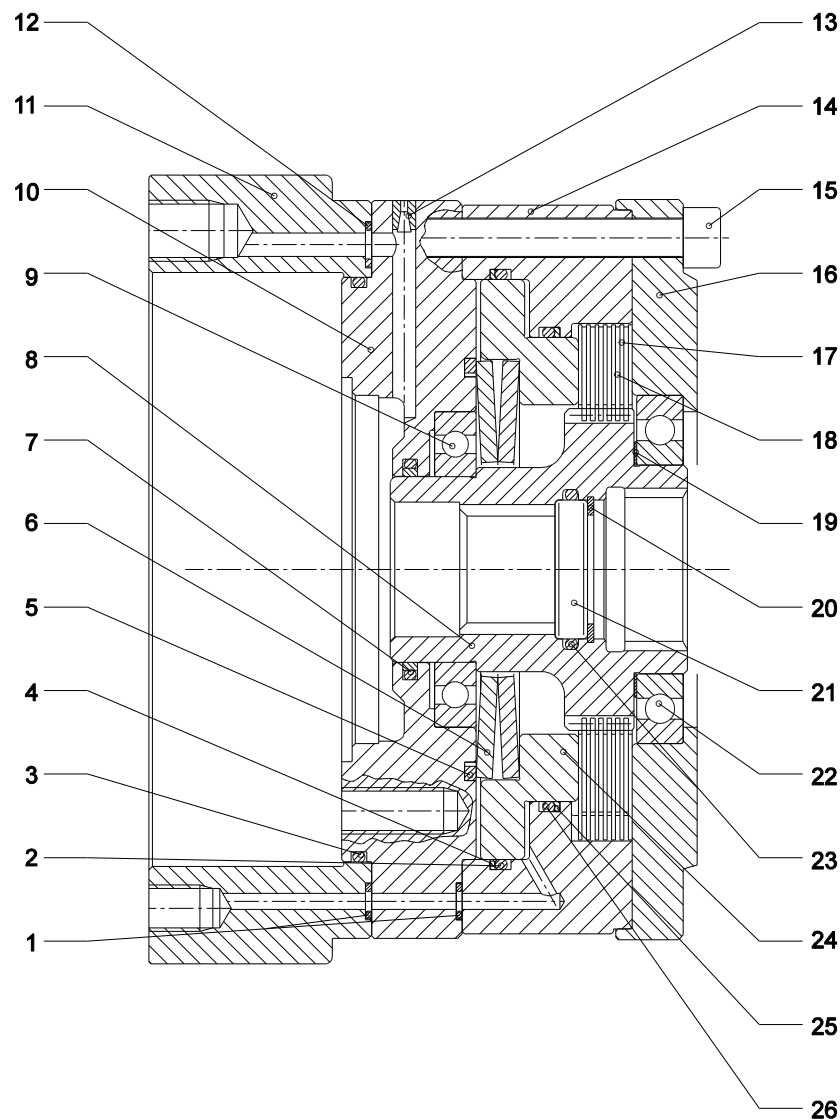

Pos	Code	Qty	Description
1	406001100	2	O-RING 2-008
2	406016700	1	OR 2-159 N 674-70 (PARKER)
3	406012500	1	O-RING 2-158
4	415067500	1	ANTIEXTRUSION PARBAK 8-159
5	415021200	1	SHOULDER RING BR 90 FOR HOLE
6	416201400	2	DISC SPRING 90X46X3,5 DIN 2093
7	415061900	1	SEAL ROTO-GLYD RING S 56131-0400-
8	02241087	1	GEAR DISK HOLDER S15 OMSU
9	400003900	1	BALL BEARING 16008 TYPE B
10	02461063	1	MOTOR FIXING FLANGE S15-S19
11	02751022	1	DRUM SUPPORT RING S15-S19 OMSU
12	406001400	1	O-RING 2-010
13	414001300	1	PLUG SK 550-050
14	02431013	1	BRAKE BODY S15
15	410404000	8	HEX SOCKET HEAD CAP SCREW M8X80 12.9
16	02461011	1	BRAKE CLOSING FLANGE S15
17	02941016	7	STEEL DISK SP 0,8 S15
18	02941017	6	STEEL BLADE SP.1 INTERNAL TOOTHED
19	427004900	1	SPACER 45X55X0,5
20	421100400	1	HOLE SEEGER Ø30
21	02741005	1	SHIMMING PAD S15 Ø30X7
22	406005800	1	O-RING 2-123 PARKER (N674-70)
23	400003000	1	BALL BEARING 16009 TYPE B
24	02271007	1	BRAKE PISTON S15
25	406015900	1	O-RING 2-155 N 741-75 (PARKER)
26	415069000	1	ANTIEXTRUSION WINCH T-2684

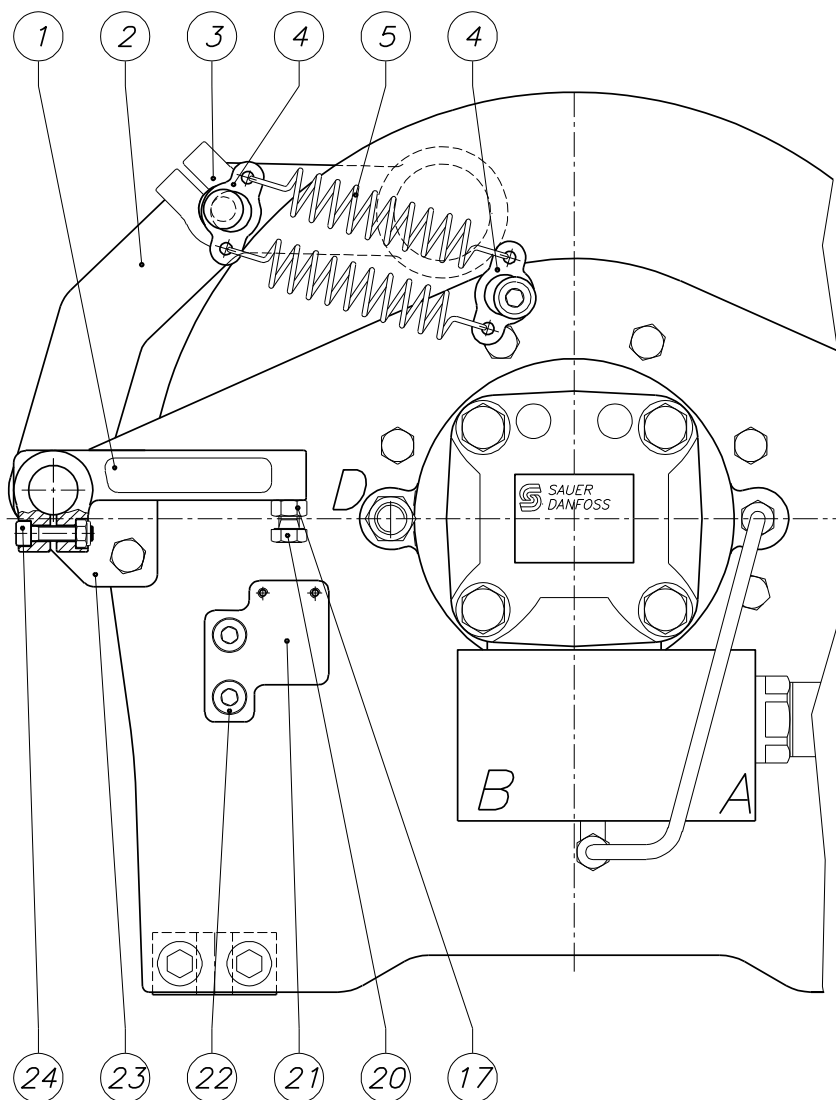

Pos	Code	Qty	Description
1	01020002	1	END STROKE LEVER (SHORT) NYLON 6
2	029917176	1	CABLE PRESS ARM TYPE 07 INOX
3	029813102	2	NYLON CLAMP GROUP Ø20
4	02490285	4	SPRING PLATE I=8
5	418205200	4	TRACTION SPRING DIM T42500 INOX
17	413002900	3	NUT M8 UNI 5588 INOX A2-70
20	410019400	5	HEX HEAD CAP SCREW M8X30 INOX A2-70
21	01020003	1	MICROSWITCH SUPPORT PLATE
22	410150600	2	HEX SOCKET HEAD CAP SCREW M8X20 INOX A2-70
23	02490275	2	INOX CABLE PRESS COUPLING PLAQUE S15/S19
24	02981308	1	SCREWS+BOLT KIT M6

Pos	Code	Qty	Description
6	02601630	1	Description not available
7	421005700	2	CLIP RING DIA 20 MM INOX
8	423010500	4	NYLON WASHER Ø20.2X31.5X1
9	400026700	4	BALL BEARING 61804 2RS
10	010105235	1	DISCHARGED ROLLER L40 Ø53X88 PLA6
11	02601629	1	Description not available
12	434010900	3	ELASTIC PIN Ø 5X30 UNI6873 INOX
13	010105100	1	CABLE PRESS ROLLER Ø53X88 ERTALON 6 PLA
14	02601628	1	Description not available
15	410083800	2	HEX SOCKET HEAD CAP SCREW M8X30 INOX UNI 5931
16	423109700	2	FLAT WASHER Ø8.4X17X1.6 INOX
17	413002900	3	NUT M8 UNI 5588 INOX A2-70
18	423203800	2	WASHER Ø21 UNI6592 INOX SHIM 3
19	423010500	6	NYLON WASHER Ø20.2X31.5X1
20	410019400	5	HEX HEAD CAP SCREW M8X30 INOX A2-70

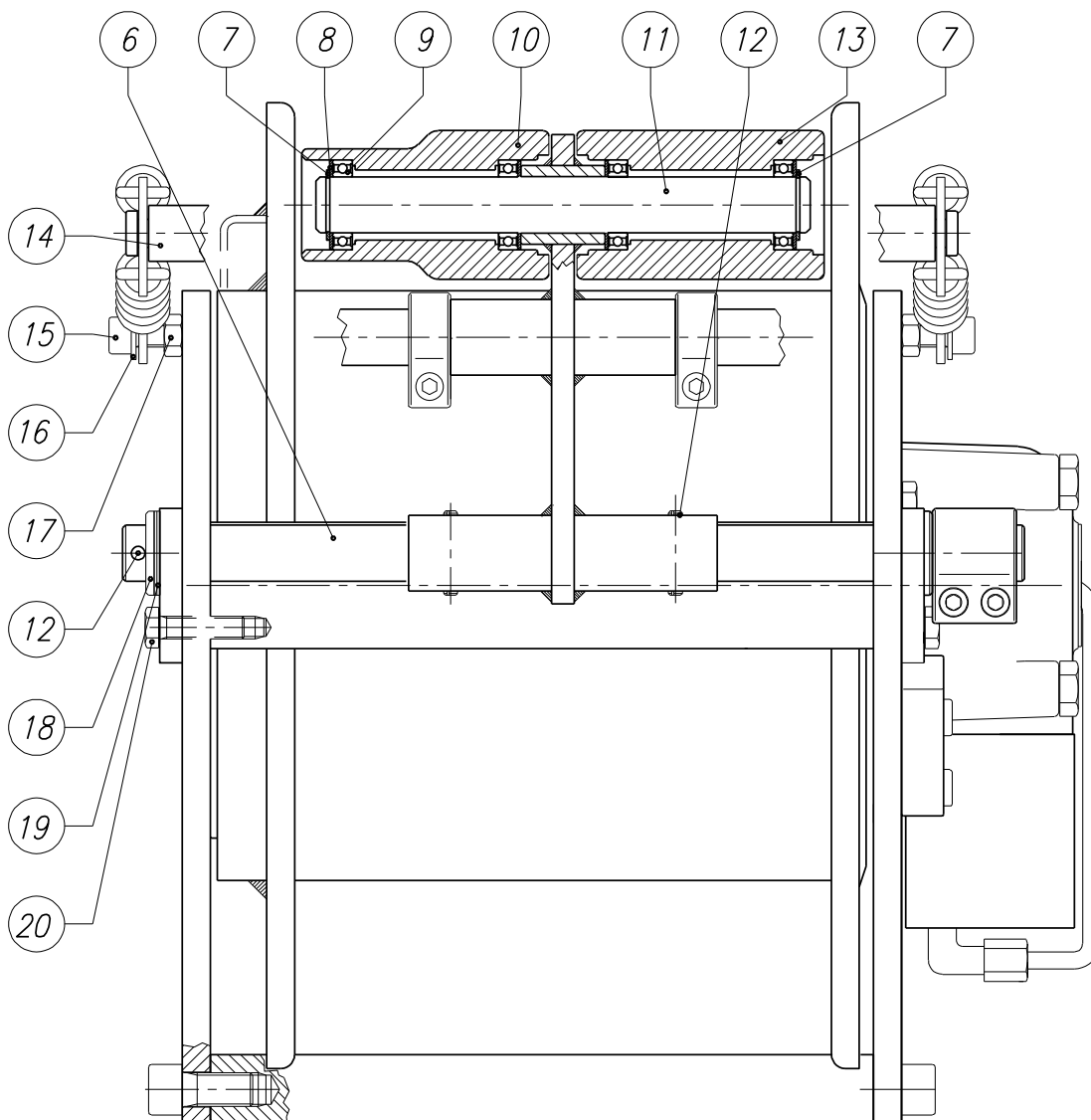

Pos	Code	Qty	Description
1	409801	1	MICROSWITCH FR501-V9
2	460100900	1	REDUCTION MF PG13,5-PG7 RTG 86782
3	460100400	1	FIXED MALE CONNECTOR PG7 RTG84310
4	410085000	2	HEX SOCKET HEAD CAP SCREW M4X40 INOX A2-70
5	423106700	2	CHAMFERED WASHER Ø4 UNI 1750 INOX

